

# Apartment 10

## Eaststand Apartments



Lower Floor

Middle Floor

Upper Floor

Lounge/Dining	5736mm x 3680mm	18'9" x 12'1"
Kitchen	2700mm x 2380mm	8'10" x 7'9"
Bedroom 1	3945mm* x 2681mm	12'11"* x 8'9"*
Bedroom 2	3294mm x 2679mm	10'9" x 8'9"
Area	77.9 m <sup>2</sup>	838.4 sq.ft

\*(max)



FOURTH FLOOR

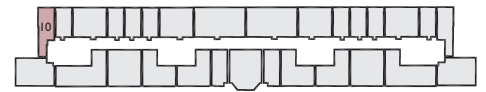

THIRD FLOOR

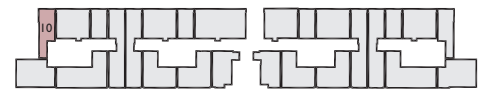

SECOND FLOOR

Energy Efficiency Rating		
	Current	Potential
<i>Very energy efficient - lower running costs</i>		
(92-plus) <b>A</b>		
(81-91) <b>B</b>		
(69-80) <b>C</b>	<b>77</b>	<b>79</b>
(55-68) <b>D</b>		
(39-54) <b>E</b>		
(21-38) <b>F</b>		
(1-20) <b>G</b>		
<i>Not energy efficient - higher running costs</i>		
<b>England &amp; Wales</b>		EU Directive 2002/91/EC

Environmental Impact (CO <sub>2</sub> ) Rating		
	Current	Potential
<i>Very environmentally friendly - lower CO<sub>2</sub> emissions</i>		
(92-plus) <b>A</b>		
(81-91) <b>B</b>		
(69-80) <b>C</b>	<b>78</b>	<b>79</b>
(55-68) <b>D</b>		
(39-54) <b>E</b>		
(21-38) <b>F</b>		
(1-20) <b>G</b>		
<i>Not environmentally friendly - higher CO<sub>2</sub> emissions</i>		
<b>England &amp; Wales</b>		EU Directive 2002/91/EC